

Quick-start guide for Dementia Support Monitor systems: (S1036A)

The S1036A is a flexible monitor system using door switches and motion detectors to assist in the care of those with dementia type symptoms. The carer is alerted via a portable Nurse Call Pager. This leaflet is a quick-start guide to installing, testing and using your system. After installation we are pleased to offer you a full system check via our telephone helpline, and would urge you to use this service. Should you wish to change any of the operating parameters or modify your system in any way, then detailed handbooks are available on request or on-line at www.alert-it.co.uk/handbooks/

Install the sensing components

Door Switches. The P161 is fitted in place on the door using either the adhesive pads supplied or screws. The white magnet is fitted on the door frame and MUST lie near the area marked SENSE when the door is closed, but a separation of 10-15mm is acceptable, making installation easy. The top of the door is suggested as this makes tampering less likely and gives simpler access for the disarming key (if required).

Ensure the correct unit is used for the door (FRONT or BACK) as these terms are used by the pager (but can be changed if required)

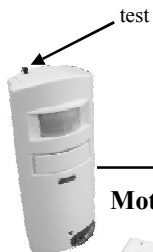

Motion Sensor: This can be mounted on a wall with the bracket supplied or positioned on the floor in a discrete location (in particular it will create a Bed Leaving alarm if positioned about 2m away from the side of a bed). Any movement within the beam will trigger an alarm

Turn on each sensor and test

Turn on the **Pager** by pressing the MENU button for 3 seconds (in the event of no response then charge the battery for at least 5 minutes)



Turn on the **P161 Door Switch** by pressing the HELP button for 5 seconds until the light comes on and then goes out. The word FRONT or BACK should flash onto the pager as appropriate. If the battery becomes discharged then a fault message will be transmitted to the pager.



Turn on the **P162 Motion Detector** by pulling out the clear battery isolation tab. Pressing the top TEST button for 1 second will cause the word MOTION to appear on the pager. After first test the keyfob needs to be paired with the unit by pointing at the front and pressing ARM, and the red light should flash

Repeat the above tests with the pager at various locations within the area of use, to validate the radio reception. In life threatening conditions the units can be changed to use the high integrity, failsafe protocol of Safelink, but this will reduce the battery life. (Contact iTs designs for details)

These tests must be repeated regularly to check the sensors and their batteries

Normal Operation

The **P161 Door Switch** is enabled by removing the red key (which can be used to turn off the alarm at any time)

Arming the P162 Motion unit:

Point the key-fob at the unit and press ARM. The red led will flash. You now have 30 seconds to leave the area without triggering the alarm

Disarming:

Point the key-fob at the unit and press DISARM within 4 seconds of entering the room. The red led will flash.

Cancelling the alarm:

Point the key-fob at the unit and press DISARM. The alarm indication on the pager will cancel.

The unit will be quite passive until the sensor is activated, when the alarm will be raised at the pager. The pager will show the alarm and will normally also sound an appropriate audible alarm (which can be silenced either permanently or for 5 minutes while attending the client). The pager can also be set to vibrate (see setup sheet).



The door activity alarm will clear once the door is re-closed. Hence the carer will be aware of the activity and need only respond as appropriate. The motion sensor will remain in an alarm state until the carer attends and cancels the alarm using the keyfob

Alarm Indications

Pager Indication	Reason	Monitor Indicates	Clear Alarm
FRONT URGENT 01	Front Door Activity	0.5 sec flash	Close door
BACK URGENT 01	Back Door Activity	0.5 sec flash	Close door
MOTION URGENT 01	Motion detected in room	Red light on	Press keyfob disarm
Any name FAULT 30	Battery Low	short flashes	Replace Battery
Any name FAULT 31	Battery Dead	short flashes	Replace Battery

Maintenance

P162 Motion Detector Batteries:

Remove the bottom screw from the rear panel and gently lever up to clear the TEST button and slide out to reveal the battery compartment. The unit requires 4 AA Manganese cells, which should last about 3 months. Replace the rear panel, ensuring the cable lies flat so not to bow the rear panel. The key-fob batteries should be replaced if the red light on that unit does not flash when a key is pressed. They are replaced by sliding open the cover. The unit requires 3 LR44 batteries. After battery replacement the key-fob needs to be paired with the main unit again (see overleaf)

System components and connection

(actual components supplied may vary to order)

Part Description	Part No
A Door Switch (2)	P161A
B on/off key	P161C
C Motion Detector	P162B
D Pager	P138B
E Power Supply for F (Universal)	P153A

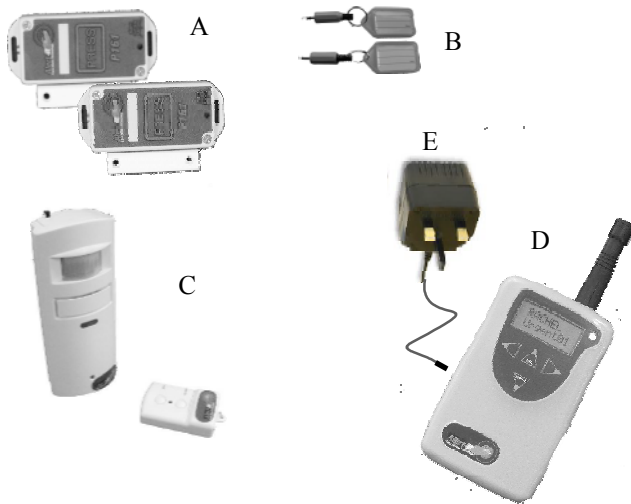

P161 Door Switch Battery:

This can be done in situ, after removing the two front screws and pulling the cover from the rear to clear the key hole. The battery needs to be ejected from the holder by pressing from inside using a thin object such as screwdriver, cocktail stick or cotton bud. Once the rim appears it can be removed. NOTE the orientation of the battery with + side down, and the seal ring visible. Fit the new battery in the same orientation. Now press the HELP button for more than 5 seconds (until red light goes out). This will re-activate your unit.

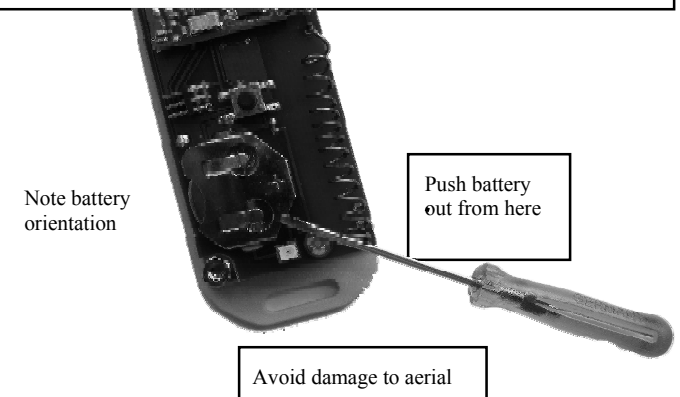

Full adjustment details are found in handbooks available on:
www.alert-it.co.uk/handbooks/
 Or by phoning Alert-iT on 0845 2179952